

# COASTGUARDS CONSERVATION AREA

## 1 INTRODUCTION

The Coastguards Conservation Area is focused on two distinct and contrasting building groups. The first is 'Seaview Terrace' a small group of two-storey cottages dating from the early 19th Century situated on the north side of Sea Front Road, with limited private land around. The second is 'Gorseway House' an early 20th Century building set within substantial landscaped grounds. This property has been converted into a Nursing Home and a number of additional buildings for this purpose have been constructed within the grounds although the original landscape framework has been respected.

## 2 HISTORICAL SIGNIFICANCE

The construction of the first road bridge to Hayling Island in 1824 was part of a project to create a new seaside resort. A number of properties were built soon after this date including Norfolk Crescent, The Royal Hotel, Stamford House and Seaview Terrace. Constructed in 1825 by the Duke of Norfolk, Seaview Terrace was built as artisans' cottages during the building of The Crescent. It was purchased by the coastguard in 1865 and remodelled to house the lifeboat men who doubled as

coastguards. Horses were stabled at the rear and these pulled the lifeboat to and from the water. The terrace continued in this use until 1914 when the lifeboat was moved to a new lifeboat station two miles to the east. For many years until 1935, the Barber Bakery, a family business which flourished for several generations was located behind the terrace.

## 3 SEAVIEW TERRACE *Its Appearance, Setting and Prominence*

This isolated terrace is the most distinctive and obvious feature of the Conservation Area. The regular arrangement of the fenestration, the parapet which runs the whole length of the building and its white painted and rendered facade contribute to its uniform appearance, which is only slightly marred by the variety of attic window styles.

The beach to the south of the Conservation Area, a broad natural area of gorse and marram grass, has remained virtually unchanged since the beginning of the century. When viewed from the beach Seaview Terrace with its white painted walls is still as prominent a feature as it must have been when it stood in isolation. This characteristic is reinforced by the fact that Seaview Terrace is situated close to the road and although

separated from the carriageway by a small paved area, the cottages do not have front gardens and are consequently not obscured by walls, fences, trees or shrub planting.

## 4 IMPORTANCE OF TREE AND SHRUB PLANTING

Gorseway House and the buildings fronting onto Seafrost Road to the east and west of the Conservation Area are set back from the road and have well landscaped front gardens. The siting of these buildings combined with the tree and shrub planting, which masks the buildings, contribute to the recessive character of the development adjacent to Seaview Terrace.

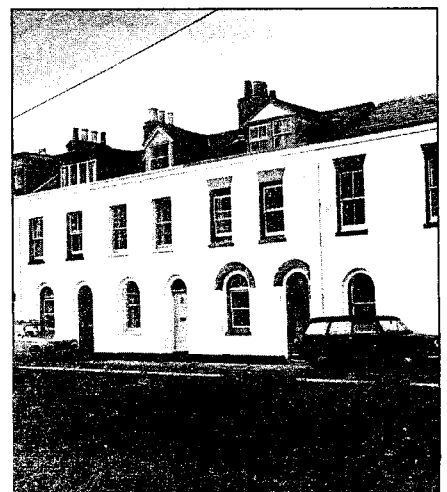

*Seaview Terrace*

# Coastguards Conservation Area

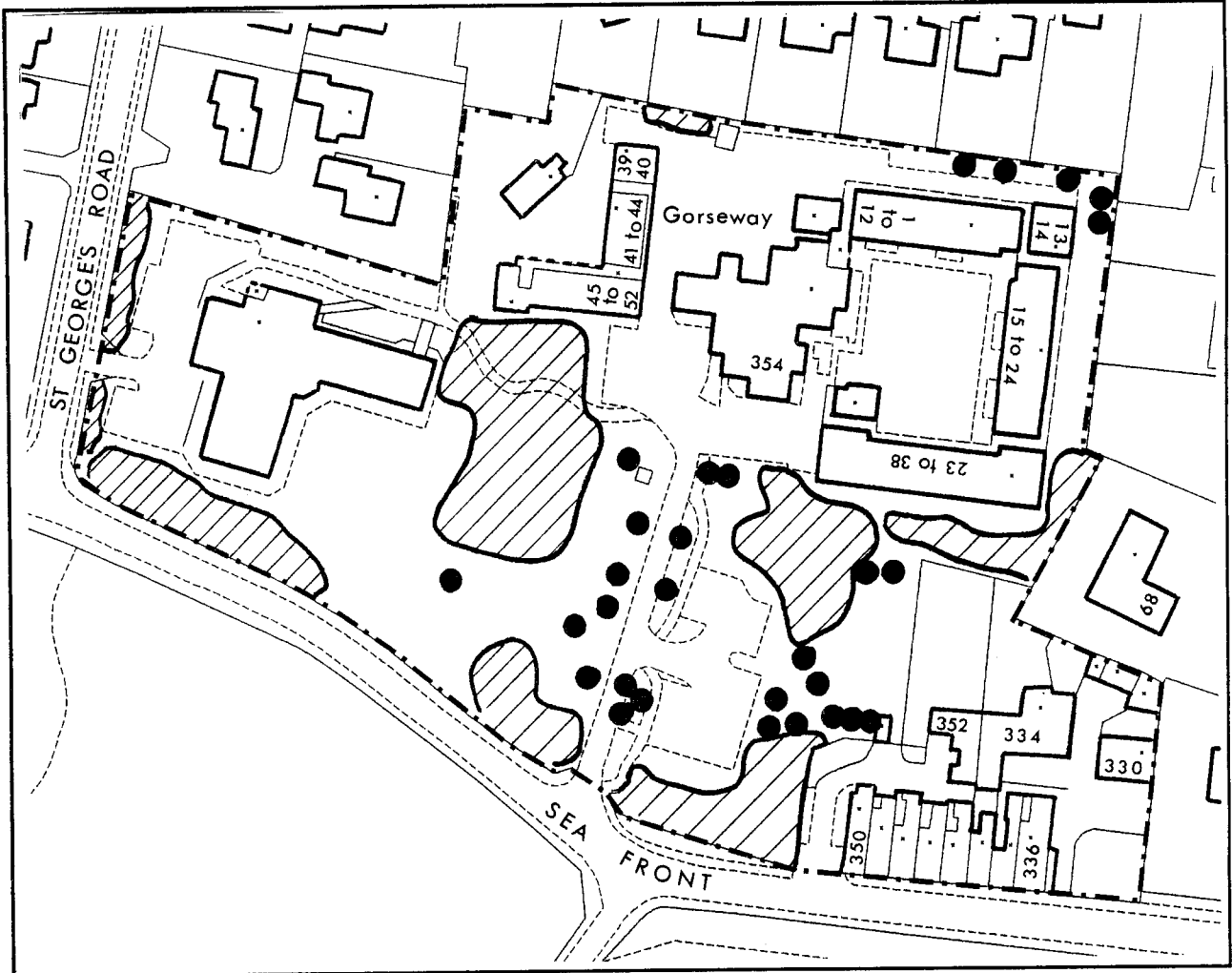

## KEY

Conservation Area Boundary



Scale

Not to Scale

Tree Preservation Orders (Individual)



Tree Preservation Orders (Groups)



North